

You have decided to buy a watch, which was assembled by a watchmaker using a Ronda movement. Please note that no watches are produced or distributed under the Ronda brand.

**In case of repairs, guarantee claims and questions concerning the functioning of a watch, purchasers and consumers should contact their retailer or the watch manufacturer, for which the relevant information can be found in the sales or guarantee documentation provided with the watch.**

**Description of the display and control buttons**

**Display elements** **Control buttons**

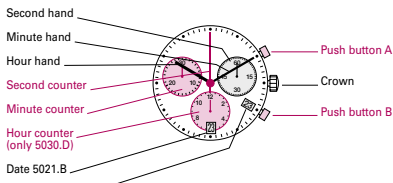

01

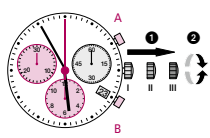

**Setting the time**

- 1\* Pull out the crown to position III (the watch stops).
- 2 Turn the crown until you reach the correct time 8:45.
- 3\* Push the crown back into position I.

**Please note:**  
\* In order to set the time to the exact second, 1 must be pulled out when the second hand is in position «60». Once the hour and minute hands have been set, 3 must be pushed back into position I at the exact second.

02

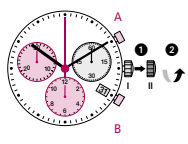

**Setting the date (quick mode)**

- 1 Pull out the crown to position II (the watch continues to run).
- 2 Turn the crown until the correct date [1] appears.
- 3 Push the crown back into position I.

**Please note:**  
During the date changing phase between approx. 9 PM and 12 PM, the date must be set to the date of the following day.

03

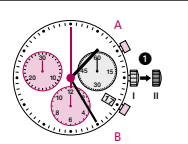

**Setting the date/time following a battery change**

Example:  
- Date / time on the watch: [12] / 1:25 AM  
- Present date / time: [4] / 8:30 PM

- 1 Pull out the crown to position II (the watch continues to run).
- 2 Turn the crown until yesterday's date appears [3].

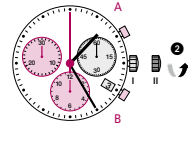

- 3\* Pull out the crown to position III (the watch stops).
- 4 Turn the crown until the correct date [4] appears.

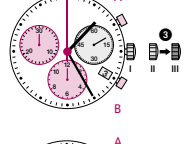

- 5\*\* Continue to turn the crown until the correct time 8:30 PM appears.
- 6 Push the crown back into position I.

**Please note:**  
\* To set your watch to the exact second, please refer to the chapter entitled «setting the time».  
\*\*Please observe the AM/PM clock rhythm.

04

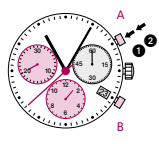

**Chronograph: Basic function**  
(Start / Stop / Reset)

- Example:
- 1 Start: Press push-button A.
  - 2 Stop: to stop the timing, press push-button A once more and read the chronograph hands: 1h / 20min / 38 sec.
  - 3 Zero positioning: Press push-button B. (The chronograph hands will be reset to their zero positions.)

05

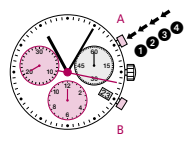

**Chronograph: Accumulated timing**

- Example:
- 1 Start: (start timing)
  - 2 Stop: (e.g. 15 min 5 sec following 1)
  - 3 Restart: (timing is resumed)
  - 4 Stop: (e.g. 5 min 12 sec following 3) = 20 min 17 sec (The accumulated measured time is shown)

**Please note:**  
\* Following 2, the accumulation of the timing can be continued by pressing push-button A (Restart / Stop, Restart / Stop, ...).

06

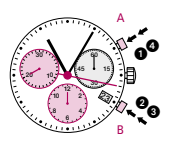

**Chronograph: Intermediate or interval timing**

- Example:
- 1 Start: (start timing)
  - 2 Display interval: e.g. 20 minutes 17 seconds (timing continues in the background)
  - 3 Making up the measured time: (The chronograph hands are quickly advanced to the ongoing measured time.)
  - 4 Stop: (Final time is displayed)
  - 5 Reset: The chronograph hands are returned to their zero position.

**Please note:**  
\* Following 2, further intervals or intermediates can be displayed by pressing push-button B (display interval / make up measured time, ...).

07

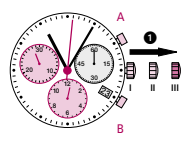

**Adjusting the chronograph hands to zero position**

Example:  
One or several chronograph hands are not in their correct zero positions and have to be adjusted (e.g. following a battery change).

- 1 Pull out the crown to position III (all chronograph hands are in their correct or incorrect zero position).
- 2 Keep push-buttons A and B depressed simultaneously for at least 2 seconds (the second counter hand rotates by 360° → corrective mode is activated).

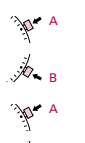

**Adjusting the second counter hand**  
Single step A 1 x short  
Continuous A long



**Adjusting the next hand B**  
Single step A 1 x short  
Continuous A long



**Adjusting the hour counter hand at 5030.D (position 6h)**  
Single step A 1 x short  
Continuous A long



**Adjusting the next hand B**  
Single step A 1 x short  
Continuous A long



**Adjusting the minute counter hand (position 9h)**  
Single step A 1 x short  
Continuous A long

- 3 Returning the crown to position I  
Termination of the chronograph hands adjustment (can be carried out at any time).

08

